



# MOIDART 5 Bedroom Detached Villa



## Room Sizes

Lounge	3991 x 7975	(13'1" x 23'2")	Excluding Door Recess
Kitchen/Dining Area	3945 x 6041	(12'11" x 19'9")	Maximum Sizes
Sitting Room	3028 x 4775	(9'11" x 15'7")	
Utility	2125 x 1789	(6'11" x 5'10")	
Toilet	2125 x 1611	(6'11" x 5'3")	Maximum Sizes
Master Bedroom	3000 x 3923	(9'10" x 12'10")	Excluding Door Recess
En Suite 1	2300 x 3072	(7'6" x 10'0")	Maximum Sizes
Bedroom 2	3456 x 2587	(11'4" x 8'5")	Excluding Door Recess
En Suite 2	2807 x 1681	(9'2" x 5'6")	Maximum Sizes
Bedroom 3	3332 x 2625	(10'11" x 8'7")	Excluding Door Recess
Bedroom 4	2842 x 2934	(9'3" x 9'7")	
Bedroom 5/Study	2842 x 2934	(9'3" x 9'7")	
Bathroom	2300 x 2909	(7'6" x 9'6")	

N.B. Room Sizes Exclude Wardrobes

**Gross Floor Area 178.44 Sq M 1920 Sq Ft**



First Floor

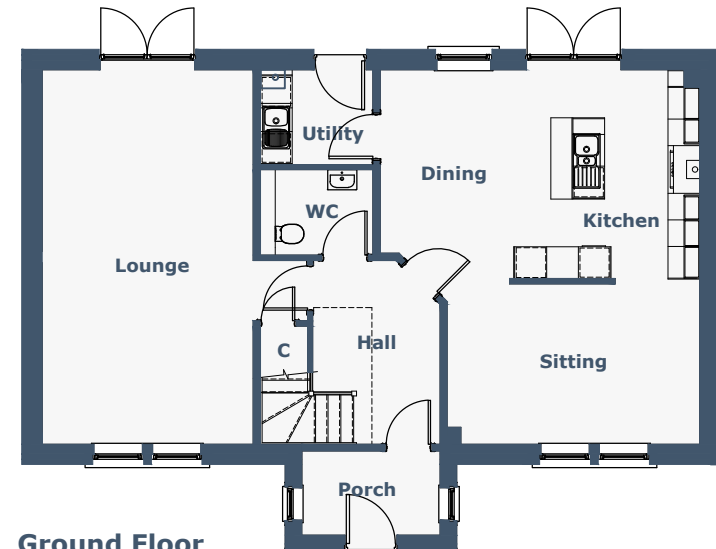

Ground Floor